

THIS MAP WAS PREPARED FOR TAX PURPOSES ONLY  
NOT TO BE USED FOR CONVEYANCE

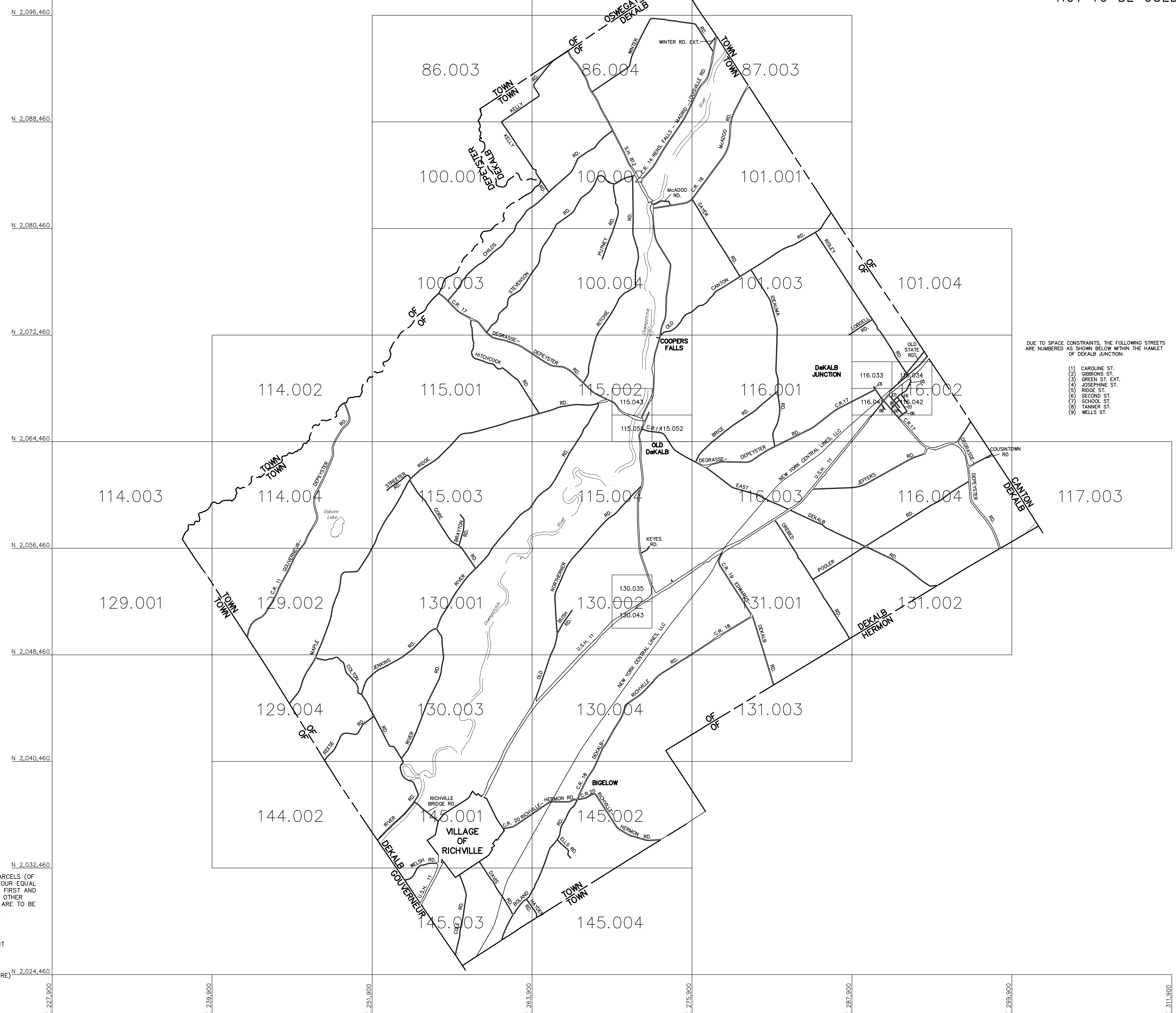
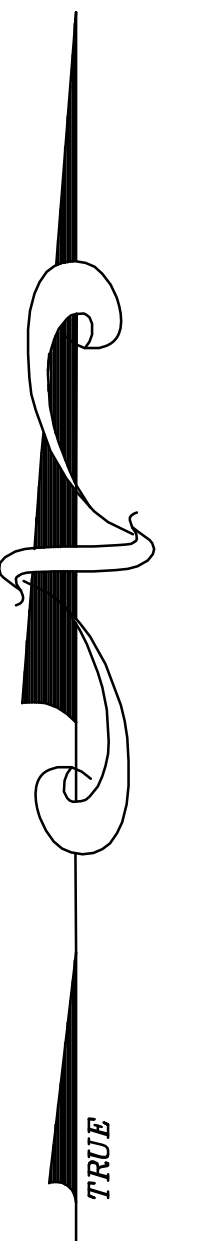

DUE TO SPACE CONSTRAINTS, THE FOLLOWING STREETS ARE NUMBERED AS SHOWN BELOW WITHIN THE HAMLET OF DEKALB JUNCTION:

- (1) CAROLINE ST.
- (2) GIBBONS ST.
- (3) GREEN ST. EXT.
- (4) JOSEPHINE ST.
- (5) RIDGE ST.
- (6) SECOND ST.
- (7) SCHOOL ST.
- (8) TANNER ST.
- (9) WELLS ST.

NOTE: A SERIES OF SQUARE OR RECTANGULAR PARCELS (OF LESS THAN ONE ACRE) HAVING TWO OR FOUR EQUAL SIDES ARE USUALLY DIMENTIONED ON THE FIRST AND LAST LINE OF THE SERIES ONLY. ALL THE OTHER PARALLEL LINES IN THIS SERIES OF LOTS ARE TO BE CONSIDERED AS BEING THE SAME LENGTH.

APPROVED BY NEW YORK BOARD OF EQUALIZATION AND ASSESSMENT

CASE NO. 1375  
J TAGGART (AUTHORIZED SIGNATURE) N 2,024,460  
DATE FEB. 14, 1978

<p><b>NOTICE OF DISCLAIMER</b></p> <p>This map represents a compilation of graphical and textual information from deeds and surveys, a planimetric base map, and digital conversions of hand drawn mylar maps. Errors and omissions can occur from each of these sources; each source represents a large number of records and originators of information. As a practical matter, the County does not warrant the accuracy or completeness of the information portrayed. The end user of these maps agrees to accept the data "as is" with the full knowledge that errors and omissions may exist, and to hold harmless the County for any damages that may result from an inappropriate use of these maps.</p>	<p><b>DRAWING LEGEND</b></p> <table style="width: 100%; border-collapse: collapse;"> <tr> <td style="width: 33%;">International Boundary</td> <td style="width: 33%;">Denotes Common Owner</td> <td style="width: 33%;">Block No.</td> </tr> <tr> <td>County Boundary</td> <td>Railroad</td> <td>Parcel No.</td> </tr> <tr> <td>Town Boundary</td> <td>Water</td> <td>Subdivision Lot No.</td> </tr> <tr> <td>Village Boundary</td> <td>Block Limit Line</td> <td>Deed Dimension</td> </tr> <tr> <td>Property or R/W Line</td> <td>Special District Line</td> <td>Scaled Dimension</td> </tr> <tr> <td></td> <td>Subdivision Lot Line</td> <td>Deed Area</td> </tr> <tr> <td></td> <td></td> <td>Calculated Area</td> </tr> </table>	International Boundary	Denotes Common Owner	Block No.	County Boundary	Railroad	Parcel No.	Town Boundary	Water	Subdivision Lot No.	Village Boundary	Block Limit Line	Deed Dimension	Property or R/W Line	Special District Line	Scaled Dimension		Subdivision Lot Line	Deed Area			Calculated Area	<p>ST. LAWRENCE COUNTY NEW YORK REAL PROPERTY</p> <p>COUNTY OFFICE BUILDING CANTON, NEW YORK 13617 (315) 379-2272 OFFICE (315) 229-3222 FAX</p>	<p><b>GRAPHIC SCALE</b></p> <p>( IN FEET ) 1 inch = 3000ft.</p>	<table border="1" style="width: 100%; border-collapse: collapse;"> <tr><td>7</td><td></td><td></td><td></td></tr> <tr><td>6</td><td></td><td></td><td></td></tr> <tr><td>5</td><td></td><td></td><td></td></tr> <tr><td>4</td><td></td><td></td><td></td></tr> <tr><td>3</td><td></td><td></td><td></td></tr> <tr><td>2</td><td></td><td></td><td></td></tr> <tr><td>1</td><td></td><td></td><td></td></tr> </table> <p>REVISIONS      DATE      BY</p>	7				6				5				4				3				2				1				<p><b>KEY MAP</b></p> <p>YOU ARE HERE</p>	<p>TOWN OF: <b>DEKALB</b></p> <p>DISTRICT NO.: <b>403089</b></p> <p>Date of Completion: 12/29/2009 JIM</p>	<p>SECTION NO.</p> <p style="font-size: 2em; text-align: center;"><b>INDEX</b></p> <p>PROPERTY MAP</p>
International Boundary	Denotes Common Owner	Block No.																																																						
County Boundary	Railroad	Parcel No.																																																						
Town Boundary	Water	Subdivision Lot No.																																																						
Village Boundary	Block Limit Line	Deed Dimension																																																						
Property or R/W Line	Special District Line	Scaled Dimension																																																						
	Subdivision Lot Line	Deed Area																																																						
		Calculated Area																																																						
7																																																								
6																																																								
5																																																								
4																																																								
3																																																								
2																																																								
1																																																								