

UNLESS DRAWN OTHERWISE, ALL PROPERTIES ARE WITHIN THE FOLLOWING DISTRICTS:

SCHOOL	402001	WATER	
FIRE	10033	SEWER	SW01
LIGHT	11033	AGRICULTURAL	

THIS MAP WAS PREPARED FOR TAX PURPOSES ONLY
NOT TO BE USED FOR CONVEYANCE

NOTICE OF DISCLAIMER

This map represents a compilation of graphical and textual information from deeds and surveys, a planimetric base map, and digital conversions of hand drawn mylar maps. Errors and omissions can occur from each of these sources; each source represents a large number of records and originators of information. As a practical matter, the County does not warrant the accuracy or completeness of the information portrayed. The end user of these maps agrees to accept the data "as is" with the full knowledge that errors and omissions may exist, and to hold harmless the County for any damages that may result from an inappropriate use of these maps.

DRAWING LEGEND

International Boundary	— — — — —	Denotes Common Owner	①
County Boundary	— — — — —	Railroad	27
Town Boundary	— — — — —	Water	(10)
Village Boundary	— — — — —	Block Limit Line	112
Property or R/W Line	— — — — —	Special District Line	27*
		Subdivision Lot Line	(27.3)

Block No.	①
Parcel No.	27
Subdivision Lot No.	112
Deed Dimension	27*
Scaled Dimension	(27.3)
Deed Area	
Calculated Area	148.2A(c)

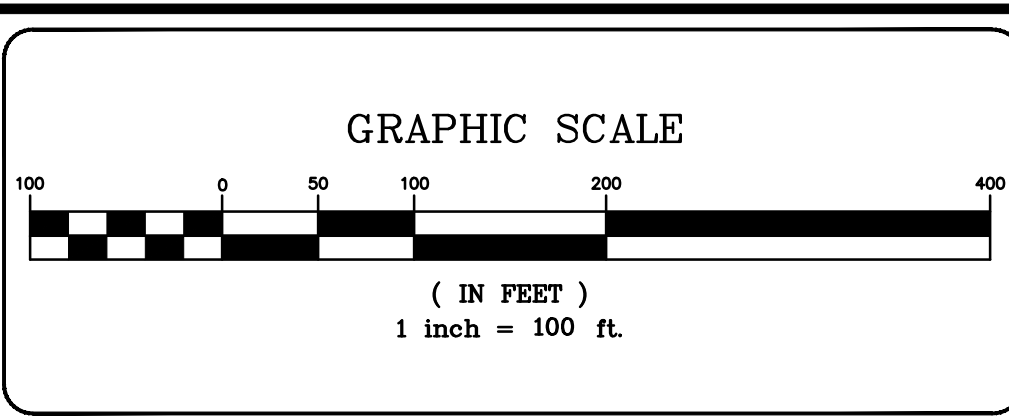

NO.	REVISIONS	DATE	BY
7			
6			
5			
4			
3			
2			
1			

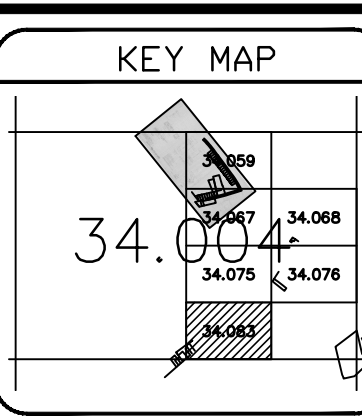

TOWN OF: STOCKHOLM
DISTRICT NO.: 408000
Date of Conversion: 03/01/09 LDC

SECTION NO.
34.083
PROPERTY MAP