

UNLESS DRAWN OTHERWISE, ALL PROPERTIES ARE WITHIN THE FOLLOWING DISTRICTS :

SCHOOL 407402 WATER  
 FIRE SENECA  
 LIGHT AGRICULTURAL

THIS MAP WAS PREPARED FOR TAX PURPOSES ONLY  
 NOT TO BE USED FOR CONVEYANCE

**NOTICE OF DISCLAIMER**

This map represents a compilation of graphical and textual information from deeds and surveys, a planimetric base map, and digital conversions of hand drawn mylar maps. Errors and omissions can occur from each of these sources; each source represents a large number of records and originators of information. As a practical matter, the County does not warrant the accuracy or completeness of the information portrayed. The end user of these maps agrees to accept the data "as is" with the full knowledge that errors and omissions may exist, and to hold harmless the County for any damages that may result from an inappropriate use of these maps.

**DRAWING LEGEND**

International Boundary ———  
 County Boundary ———  
 Town Boundary ———  
 Village Boundary ———  
 Property or R/W Line ———

Denotes Common Owner Railroad  
 Water  
 Block Limit Line  
 Special District Line  
 Subdivision Lot Line

Block No. ①  
 Parcel No. 27  
 Subdivision Lot No. (10)  
 Deed Dimension 112'  
 Scaled Dimension 27'  
 Deed Area (27.3)  
 Calculated Area 148.2A(c)

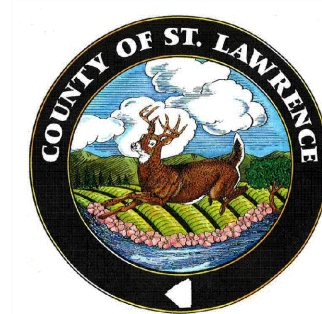

ST. LAWRENCE COUNTY  
 NEW YORK  
 REAL PROPERTY  
 COUNTY OFFICE BUILDING  
 CANTON, NEW YORK 13617  
 (315) 379-2272 OFFICE  
 (315) 229-3222 FAX

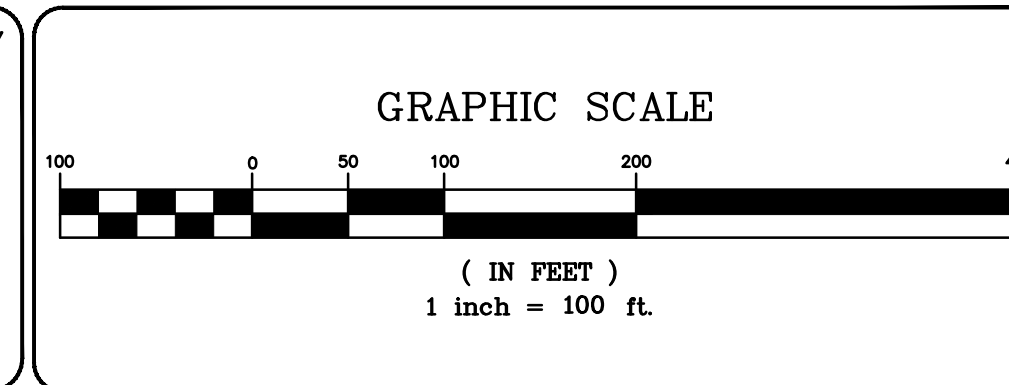

7			
6			
5			
4			
3			
2			
1			
REVISIONS		DATE	BY

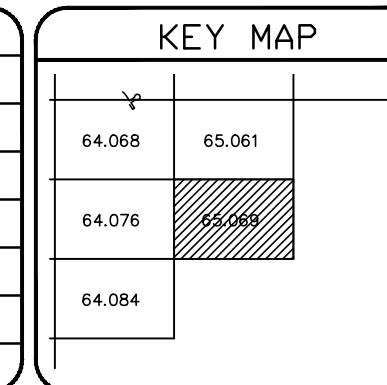

VILLAGE OF: POTSDAM  
 DISTRICT NO.: 407403  
 Date of Conversion: 01/09/07 FJL

SECTION NO.  
 65.069  
 PROPERTY MAP