



UNLESS DRAWN OTHERWISE, ALL PROPERTIES ARE WITHIN THE FOLLOWING DISTRICTS:

SCHOOL 404602 WATER
FIRE 75074 SEWER
LIGHT AGRICULTURAL

THIS MAP WAS PREPARED FOR TAX PURPOSES ONLY
NOT TO BE USED FOR CONVEYANCE

NOTICE OF DISCLAIMER

This map represents a compilation of graphical and textual information from deeds and surveys, a planimetric base map, and digital conversions of hand drawn mylar maps. Errors and omissions can occur from each of these sources; each source represents a large number of records and originators of information. As a practical matter, the County does not warrant the accuracy or completeness of the information portrayed. The user of these maps agrees to accept the data "as is" with the full knowledge that errors and omissions may exist, and to hold harmless the County for any damages that may result from an inappropriate use of these maps.

DRAWING LEGEND

International Boundary
County Boundary
Town Boundary
Village Boundary
Property or R/W Line

Denotes Common Owner
Railroad
Water
Block Limit Line
Special District Line
Subdivision Lot Line

Block No. ①
Parcel No. 27
Subdivision Lot No. 112
Deed Dimension 27's
Scaled Dimension 27.3's
Deed Area 148.2A(c)
Calculated Area



ST. LAWRENCE COUNTY
NEW YORK
REAL PROPERTY
COUNTY OFFICE BUILDING
CANTON, NEW YORK 13617
(315) 379-2272 OFFICE
(315) 229-3222 FAX

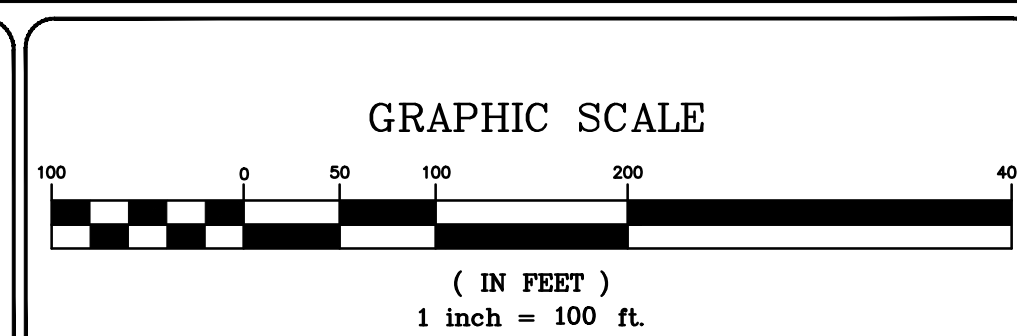

| | | | |
|-----------|--|------|----|
| 7 | | | |
| 6 | | | |
| 5 | | | |
| 4 | | | |
| 3 | | | |
| 2 | | | |
| 1 | | | |
| REVISIONS | | DATE | BY |

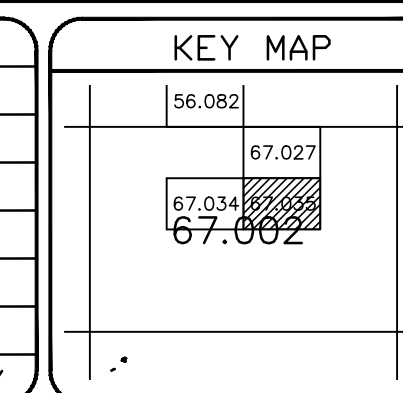

TOWN OF: HOPKINTON
DISTRICT NO.: 404600
Date of Conversion 03/01/08 LDC

SECTION NO.
67.035
PROPERTY MAP