

UNLESS DRAWN OTHERWISE, ALL PROPERTIES ARE WITHIN THE FOLLOWING DISTRICTS:

SCHOOL	40001	WATER	_____
FIRE	70001	SEWER	_____
LIGHT	_____	AGRICULTURAL	_____

THIS MAP WAS PREPARED FOR TAX PURPOSES ONLY  
NOT TO BE USED FOR CONVEYANCE

**NOTICE OF DISCLAIMER**

This map represents a compilation of graphical and textual information from deeds and surveys, a planimetric base map, and digital conversions of hand drawn meter maps. Errors and omissions can occur from each of these sources; each source represents a large number of records and originators of information. As a practical matter, the County does not warrant the accuracy or completeness of the information portrayed. The use of these maps agrees to accept the data "as is" with the full knowledge that errors and omissions may exist, and to hold harmless the County for any damages that may result from an inappropriate use of these maps.

**DRAWING LEGEND**

International Boundary	_____	Denotes Common Owner	_____
Town Boundary	_____	Railroad	_____
Village Boundary	_____	Water	_____
Property or R/W Line	_____	Block Limit Line	_____
		Special District Line	_____
		Subdivision Lot Line	_____

Block No.	①
Parcel No.	27
Subdivision Lot No.	112
Deed Dimension	27'
Scaled Dimension	(27.3)
Deed Area	148.2A(c)
Calculated Area	148.2A(c)

ST. LAWRENCE COUNTY  
NEW YORK  
REAL PROPERTY  
COUNTY OFFICE BUILDING  
CANTON, NEW YORK 13617  
(315) 379-2272 OFFICE  
(315) 229-3222 FAX

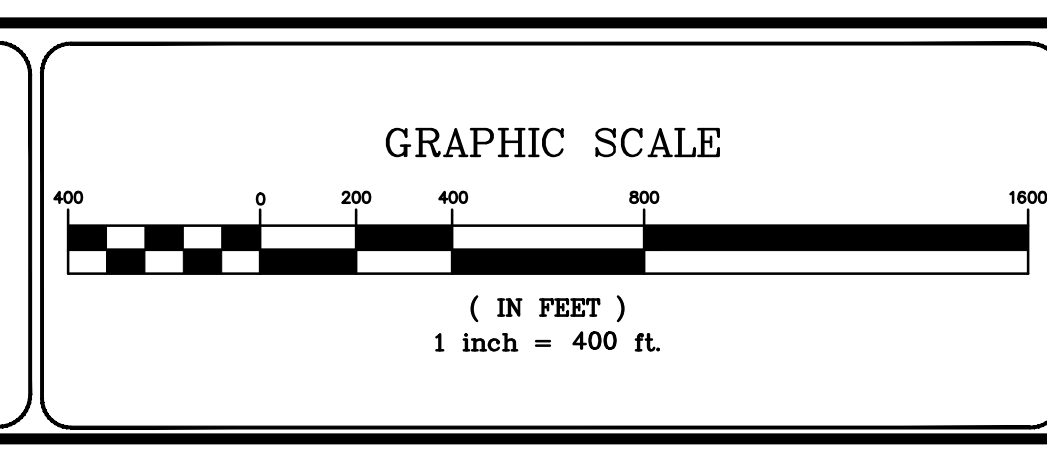

NO.	REVISIONS	DATE	BY
7			
6			
5			
4			
3			
2			
1			

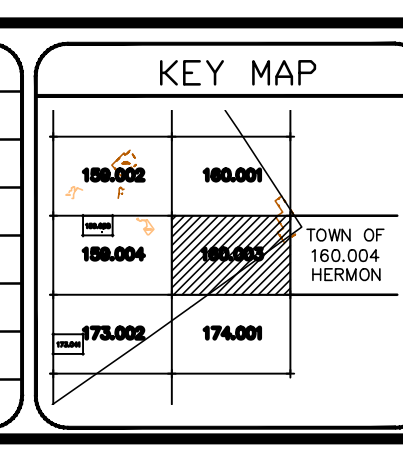

TOWN OF: **GOVERNEUR**  
DISTRICT NO.: **404089**  
Date of Conversion: 1/21/09 MRP

SECTION NO.  
**160.003**  
PROPERTY MAP