

N 2,202,460
 N 2,200,460
 N 2,198,460
 N 2,196,460
 N 2,194,460
 N 2,192,460
 N 2,190,460

E 3,051,900
 E 3,098,900
 E 3,111,900
 E 3,114,900
 E 3,171,900

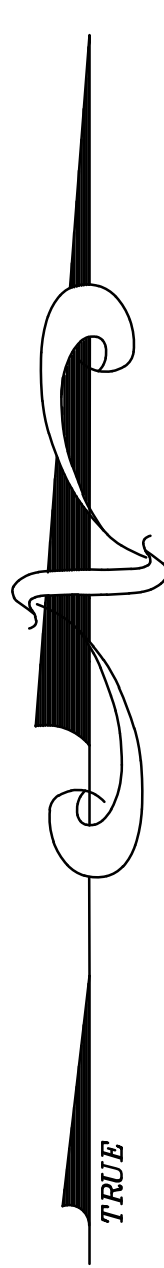
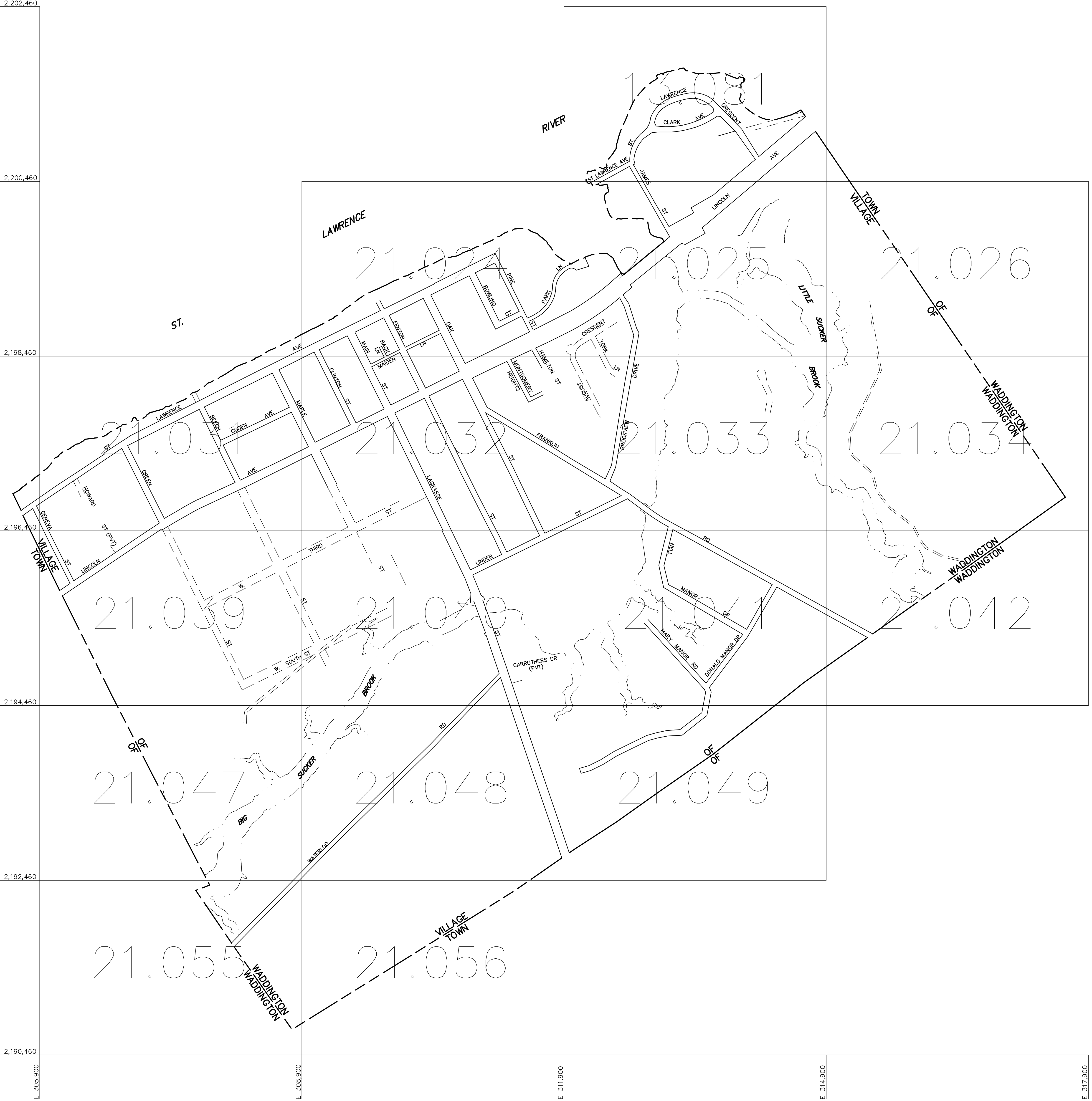

NOTE: A SERIES OF SQUARE OR RECTANGULAR PARCELS (OF LESS THAN ONE ACRE) HAVING TWO OR FOUR EQUAL SIDES ARE USUALLY DIMENSIONED ON THE FIRST AND LAST LINE OF THE SERIES ONLY. ALL THE OTHER PARALLEL LINES IN THIS SERIES OF LOTS ARE TO BE CONSIDERED AS BEING THE SAME LENGTH.

APPROVED BY NEW YORK BOARD OF EQUALIZATION AND ASSESSMENT

CASE NO. 1549 J TAGGART (AUTHORIZED SIGNATURE) JUNE 8, 1979

THIS MAP WAS PREPARED FOR TAX PURPOSES ONLY
 NOT TO BE USED FOR CONVEYANCE

NOTICE OF DISCLAIMER

This map represents a compilation of graphical and textual information from deeds and surveys, a planimetric base map, and digital conversions of hand drawn mylar maps. Errors and omissions can occur from each of these sources; each source represents a large number of records and originators of information. As a practical matter, the County does not warrant the accuracy or completeness of the information portrayed. The end user of these maps agrees to accept the data "as is" with the full knowledge that errors and omissions may exist, and to hold harmless the County for any damages that may result from an inappropriate use of these maps.

DRAWING LEGEND

International Boundary	Denotes Common Owner	Block No.	27
County Boundary	Railroad	Parcel No.	112
Town Boundary	Water	Subdivision Lot No.	27
Village Boundary	Block Limit Line	Deed Dimension	27.5
Property or R/W Line	Special District Line	Scaled Dimension	27.5
	Subdivision Lot Line	Deed Area	148.2A(c)
		Calculated Area	

ST. LAWRENCE COUNTY
NEW YORK
REAL PROPERTY

COUNTY OFFICE BUILDING
 CANTON, NEW YORK 13617
 (315) 379-2272 OFFICE
 (315) 229-3222 FAX

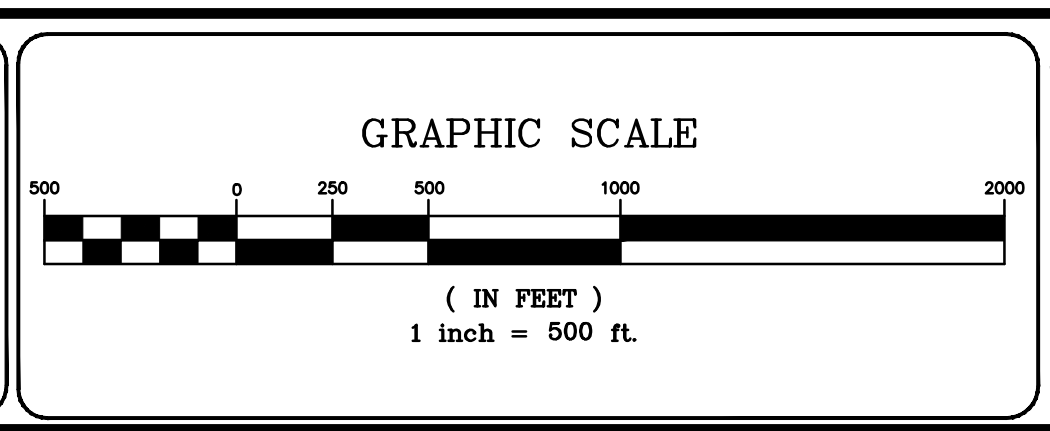

REVISIONS	DATE	BY
7		
6		
5		
4		
3		
2		
1		

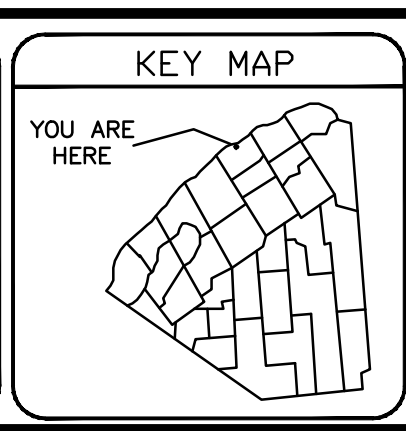

VILLAGE OF: **WADDINGTON**

DISTRICT NO.: **408201**

Date of Conversion: 04/09/07 JIM

SECTION NO.

INDEX

PROPERTY MAP