

DUE TO SPACE CONSTRAINTS, NOT ALL THE PRIVATE ROADS ARE DRAWN ON THIS INDEX MAP. THE FOLLOWING IS A LIST OF ALL THE PRIVATE ROADS AND THE CORRESPONDING SECTION NUMBER WHERE IT IS LOCATED.

- 1) BACKUS CAMP RD 86.002
- 2) BARR RD 70.003 & 70.053
- 3) CAMP RD 41 70.003 & 70.053
- 4) LIVINGSTON DRIVE 70.003 & 70.053
- 5) HELL'S RD (PVT) 70.003 & 70.053
- 6) WRIGHT CAMP DR (PVT) 70.003 & 70.053
- 7) CHARDONWAY 70.003, 70.045, 70.046 & 70.001
- 8) COUNTRY CLUB SHORES RD WEST 70.003 & 70.001
- 9) MCWEN LN (PVT) 70.001
- 10) LORD DR (PVT) 70.024
- 11) VIEWPOINT LANE 70.024
- 12) BASTA BLVD. 58.081
- 13) PECCOLO DR (PVT) 58.058 & 58.059
- 14) BRIGGS STREET 58.051
- 15) PEO'S LN (PVT) 58.051
- 16) KLONDKE RD (PVT) 58.043 & 58.051
- 17) CEDAR CROFT 70.024
- 18) CEDAR SHORES 58.051
- 19) COUNTRY CLUB SHORES RD 70.038
- 20) DUNN POINT RD 70.038 & 70.046
- 21) EEL WEIR DR. 71.001
- 22) FELL FARM RD. 70.001, 70.023 & 70.024
- 23) MEMORY LN (PVT) 84.004
- 24) CRYSTAL LN (PVT) 85.003
- 25) RIFA RD (PVT) 58.059
- 26) ROCK RD 85.001
- 27) WILSON LN (PVT) 71.001
- 28) LEE DR. 71.001, 71.048 & 71.003
- 29) FERRY RD. 70.025
- 30) RIVER LN. 71.001, 71.048 & 71.003
- 31) SWAN'S SHORE RD. 59.003
- 32) STONE HEDGE LN. 58.051
- 33) ZOWLAR RD. 85.039
- 34) BUSBY LN (PVT) 70.001
- 35) HOWES PINE VIEW LN (PVT) 71.001 & 71.048
- 36) SLEEPY HOLLOW LN (PVT) 59.003

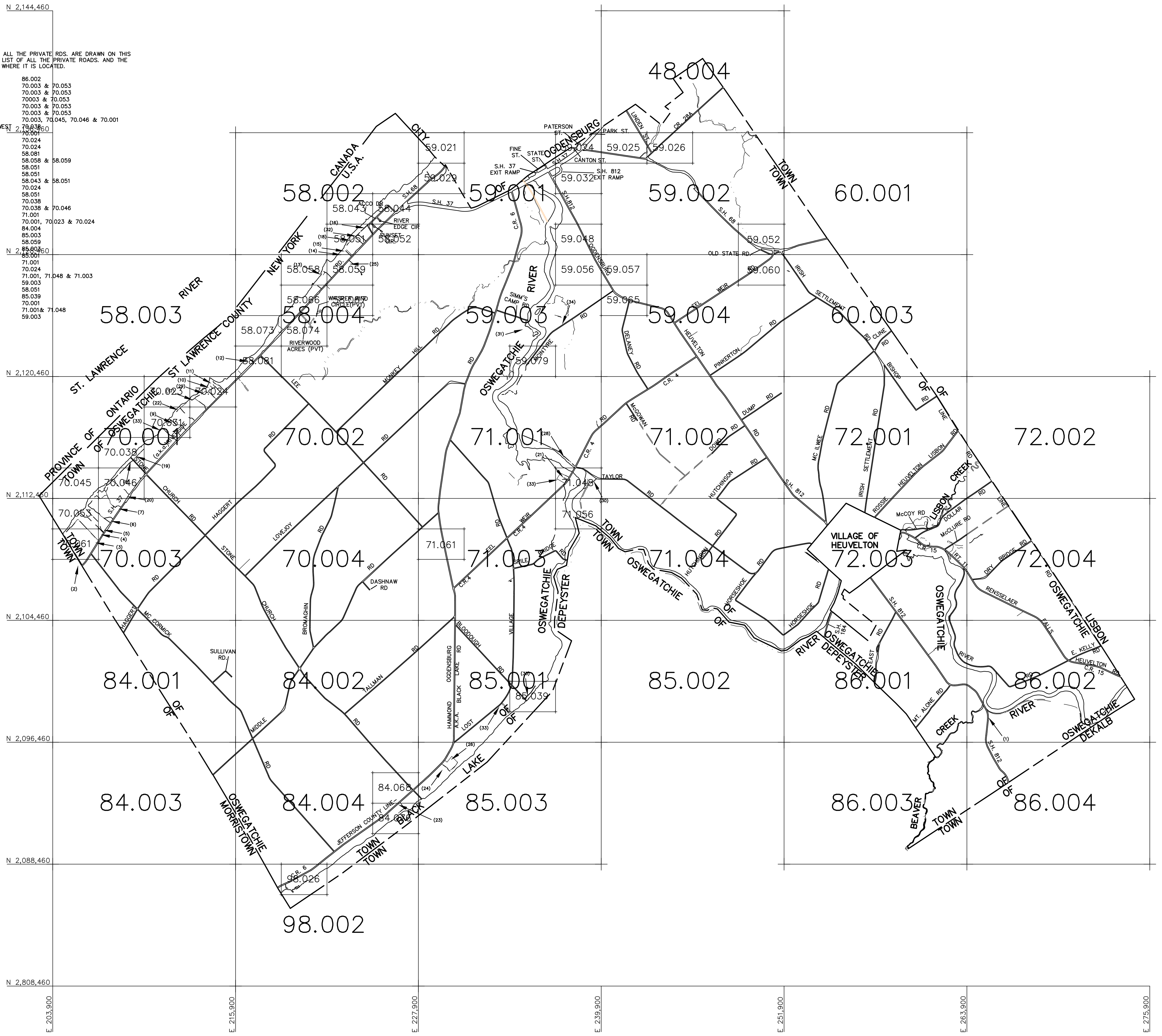

NOTE: A SERIES OF SQUARE OR RECTANGULAR PARCELS (OF LESS THAN ONE ACRE) HAVING TWO OR FOUR EQUAL SIDES ARE USUALLY DIMENSIONED ON THE FIRST AND LAST LINE OF THE SERIES ONLY. ALL THE OTHER PARALLEL LINES IN THIS SERIES OF LOTS ARE TO BE CONSIDERED AS BEING THE SAME LENGTH.

APPROVED BY NEW YORK BOARD OF EQUALIZATION AND ASSESSMENT
CASE NO. 1549 J TAGGART (AUTHORIZED SIGNATURE)
JUNE 8, 1979

THIS MAP WAS PREPARED FOR TAX PURPOSES ONLY
NOT TO BE USED FOR CONVEYANCE

NOTICE OF DISCLAIMER

This map represents a compilation of graphical and textual information from deeds and surveys, a planimetric base map, and digital conversions of hand drawn mylar maps. Errors and omissions can occur from each of these sources; each source represents a large number of records and originators of information. As a practical matter, the County does not warrant the accuracy or completeness of the information portrayed. The end user of these maps agrees to accept the data "as is" with the full knowledge that errors and omissions may exist, and to hold harmless the County for any damages that may result from an inappropriate use of these maps.

DRAWING LEGEND

- International Boundary
- County Boundary
- Town Boundary
- Village Boundary
- Property or R/W Line

Denotes Common Owner

Railroad

Block Limit Line

Special District Line

Subdivision Lot Line

Block No. **1**

Parcel No. 27

Subdivision Lot No. (10)

Deed Dimension 112'

Scaled Dimension 27'

Deed Area (27.3)

Calculated Area 148.2A(c)

ST. LAWRENCE COUNTY
NEW YORK
REAL PROPERTY
COUNTY OFFICE BUILDING
CANTON, NEW YORK 13617
(315) 379-2272 OFFICE
(315) 229-3222 FAX

GRAPHIC SCALE

(IN FEET)
1 inch = 3000ft.

7	6	5	4	3	2	1
REVISIONS						

KEY MAP

TOWN OF: **OSWEGATCHIE**

DISTRICT NO.: **406489**

Date of Conversion: 11/1/2010 LDC

SECTION NO.

INDEX

PROPERTY MAP