



UNLESS DRAWN OTHERWISE, ALL PROPERTIES ARE WITHIN THE FOLLOWING DISTRICTS:

SCHOOL 405601, 406201	WATER _____
FIRE 195028	SEWER _____
LIGHT _____	AGRICULTURAL _____

THIS MAP WAS PREPARED FOR TAX PURPOSES ONLY
NOT TO BE USED FOR CONVEYANCE

NOTICE OF DISCLAIMER

This map represents a compilation of graphical and textual information from deeds and surveys, a planimetric base map, and digital conversions of hand drawn mylar maps. Errors and omissions can occur from each of these sources; each source represents a large number of records and originators of information. As a practical matter, the County does not warrant the accuracy or completeness of the information portrayed. The end user of these maps agrees to accept the data "as is" with the full knowledge that errors and omissions may exist, and to hold harmless the County for any damages that may result from an inappropriate use of these maps.

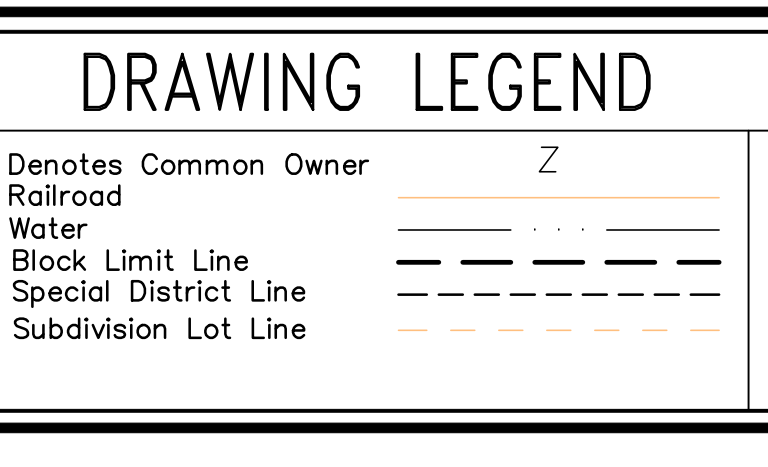
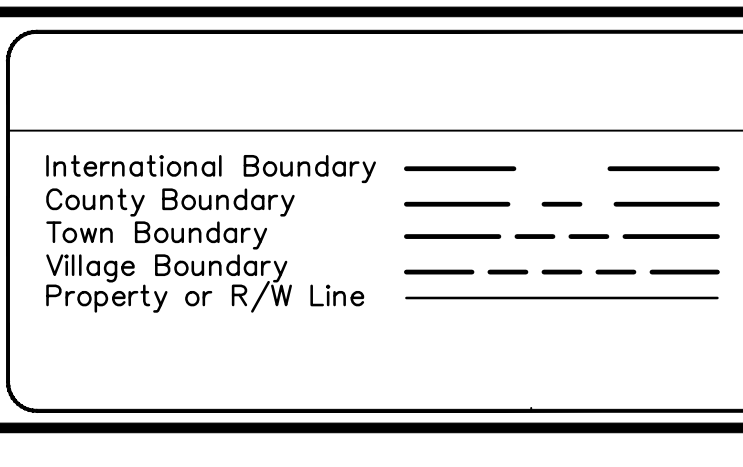

Block No.	1
Subdivision Lot No.	27
Deed Dimension	112'
Scaled Dimension	27'
Deed Area	27.3
Calculated Area	148.2A(c)

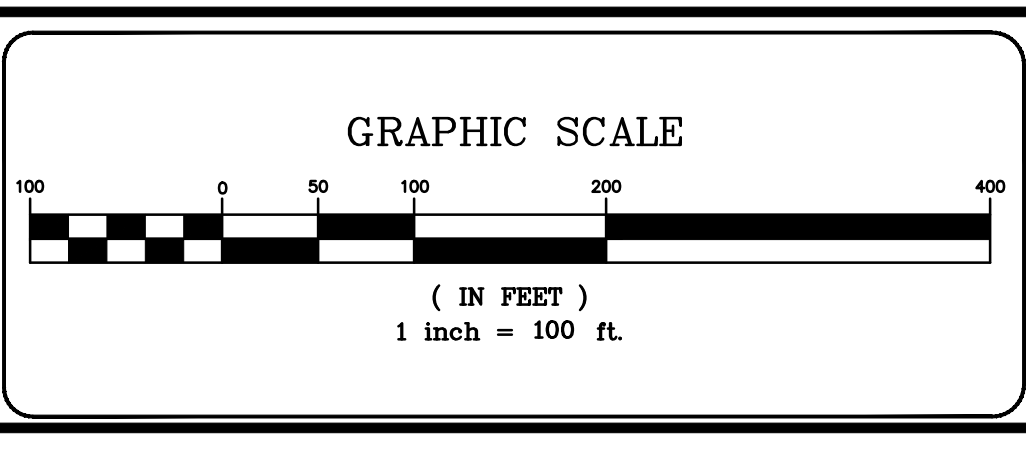

	7	6	5	4	3	2	1
REVISIONS							
DATE							
BY							

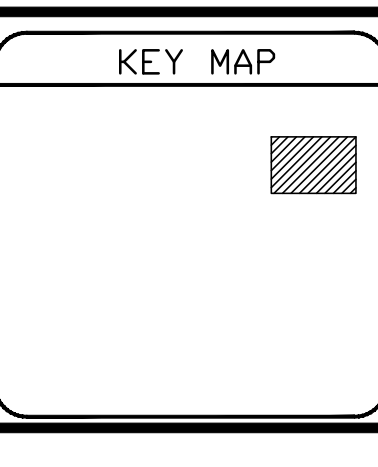

TOWN OF: **OSWEGATCHIE**

DISTRICT NO.: **406489**

Date of Conversion: 11/1/2010 LDC

SECTION NO. **59.060**

PROPERTY MAP