

N 2,064,460  
E 203,900

E 215,900  
N 2,064,460

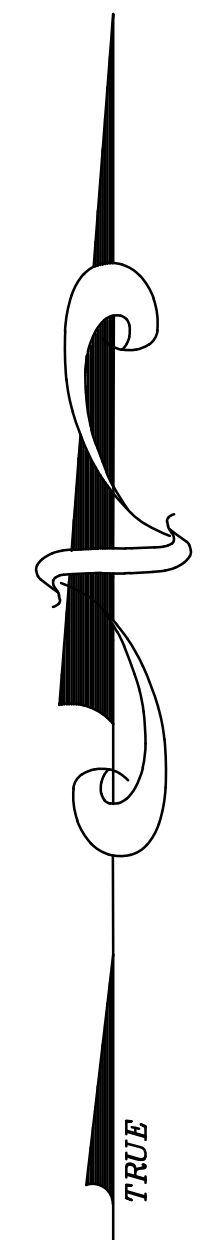
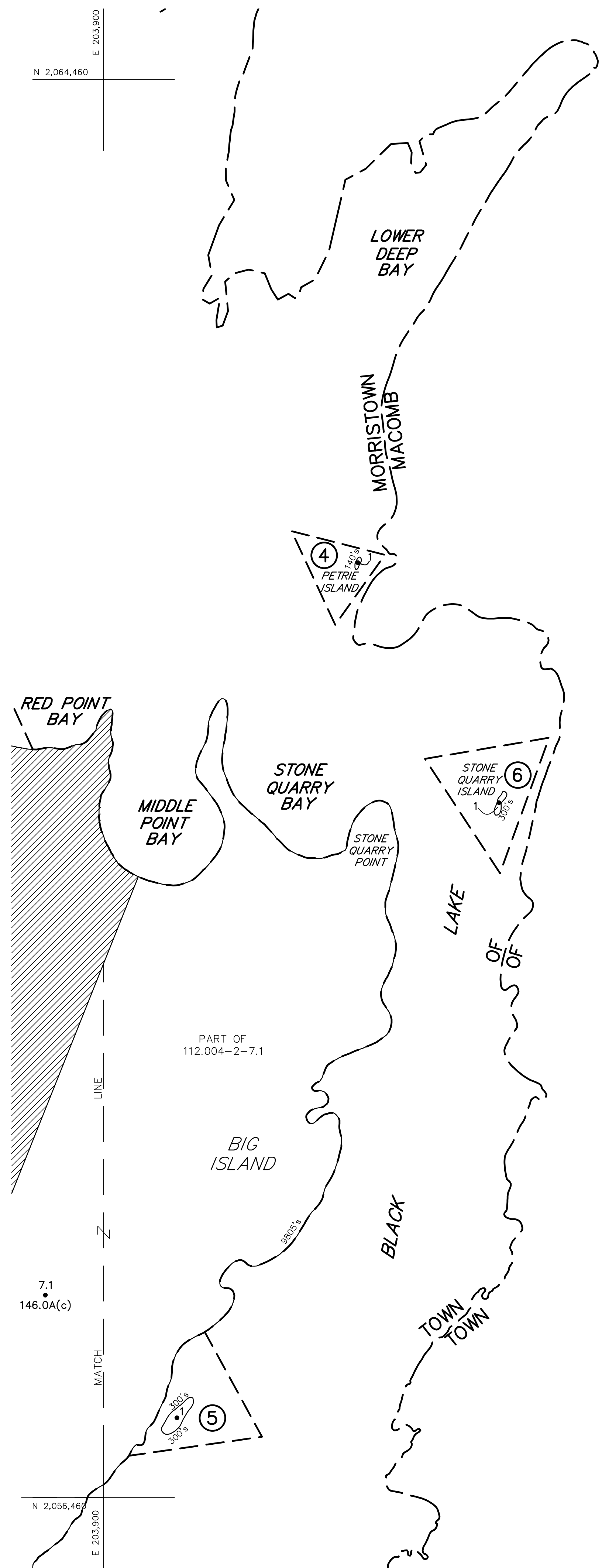

UNLESS DRAWN OTHERWISE, ALL PROPERTIES ARE WITHIN THE FOLLOWING DISTRICTS:

SCHOOL 404201 WATER  
FIRE 700201 SENIOR  
LIGHT 700201 AGRICULTURAL

THIS MAP WAS PREPARED FOR TAX PURPOSES ONLY  
NOT TO BE USED FOR CONVEYANCE

**NOTICE OF DISCLAIMER**

This map represents a compilation of graphical and textual information from deeds and surveys, a planimetric base map, and digital conversions of hand drawn mylar maps. Errors and omissions can occur from each of these sources; each source represents a large number of records and originators of information. As a practical matter, the County does not warrant the accuracy or completeness of the information portrayed. The end user of these maps agrees to accept the data "as is" with the full knowledge that errors and omissions may exist, and to hold harmless the County for any damages that may result from an inappropriate use of these maps.

**DRAWING LEGEND**

International Boundary	—————	Denotes Common Owner	①
County Boundary	—————	Railroad	27
Town Boundary	—————	Water	(10)
Village Boundary	—————	Block Limit Line	112
Property or R/W Line	—————	Special District Line	27*
		Subdivision Lot Line	(27.3)
		Calculated Area	148.2A(c)

ST. LAWRENCE COUNTY  
NEW YORK  
REAL PROPERTY  
COUNTY OFFICE BUILDING  
CANTON, NEW YORK 13617  
(315) 379-2272 OFFICE  
(315) 229-3222 FAX

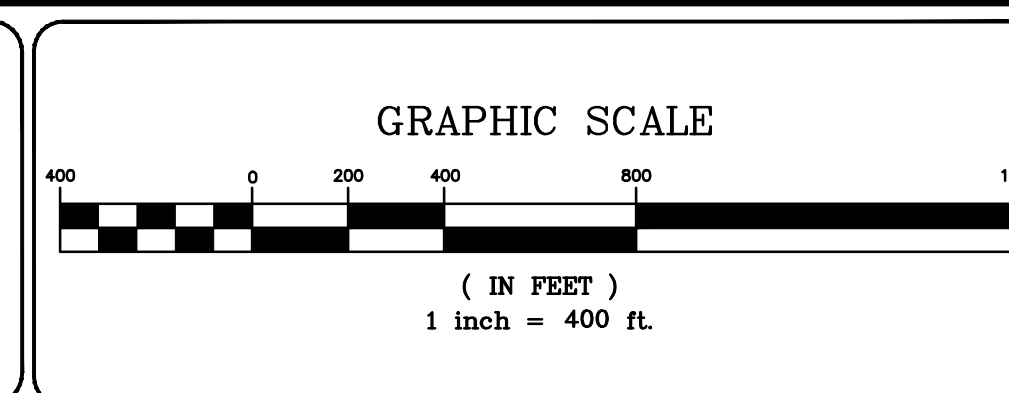

7			
6			
5			
4			
3			
2			
1			
	REVISIONS	DATE	BY

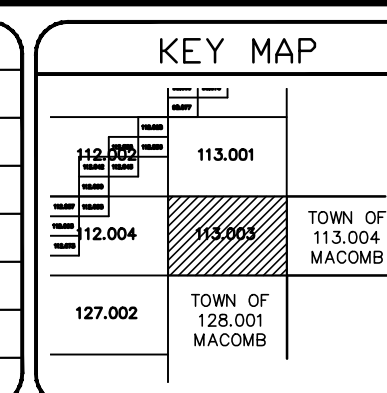

TOWN OF: MORRISTOWN  
DISTRICT NO.: 406089  
Date of Conversion: 12/19/08 JIM

SECTION NO.  
**113.003**  
PROPERTY MAP