

UNLESS DRAWN OTHERWISE, ALL PROPERTIES ARE WITHIN THE FOLLOWING DISTRICTS :

SCHOOL 405021 WATER 590022
 FIRE 470024 SEWER 590022
 LIGHT 470020 AGRICULTURAL 590022

THIS MAP WAS PREPARED FOR TAX PURPOSES ONLY
 NOT TO BE USED FOR CONVEYANCE

NOTICE OF DISCLAIMER

This map represents a compilation of graphical and textual information from deeds and surveys, a planimetric base map, and digital conversions of hand drawn map or maps. Errors and omissions can occur from each of these sources; each source represents a large number of records and originators of information. As a practical matter, the County does not warrant the accuracy or completeness of the information portrayed. The end user of these maps agrees to accept the data "as is" with the full knowledge that errors and omissions may exist, and to hold harmless the County for any damages that may result from an inappropriate use of these maps.

DRAWING LEGEND

International Boundary County Boundary Town Boundary Village Boundary Property or R/W Line

Denotes Common Owner Railroad Water Block Limit Line Special District Line Subdivision Lot Line

Block No. **1**
 Parcel No. 27
 Subdivision Lot No. (10)
 Deed Dimension 112'
 Scaled Dimension 27'
 Deed Area (27.31)
 Calculated Area 148.2A(c)

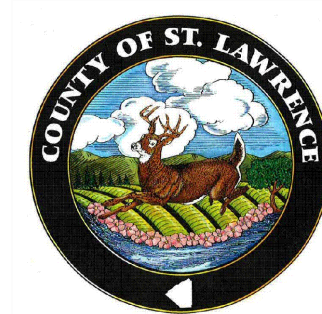

ST. LAWRENCE COUNTY
NEW YORK
REAL PROPERTY
 COUNTY OFFICE BUILDING
 CANTON, NEW YORK 13617
 (315) 379-2272 OFFICE
 (315) 229-3222 FAX

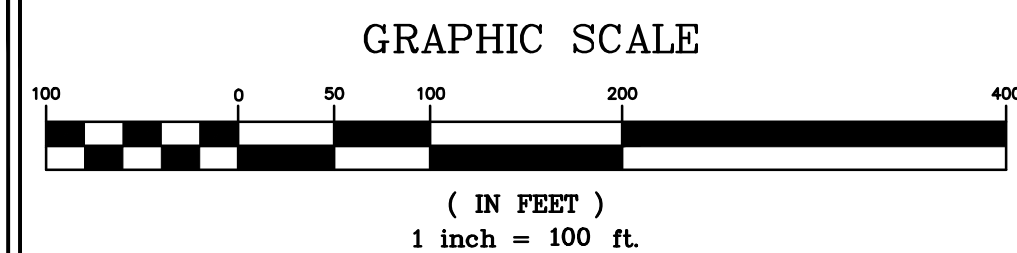

7			
6			
5			
4			
3			
2			
1	REVISIONS	DATE	BY

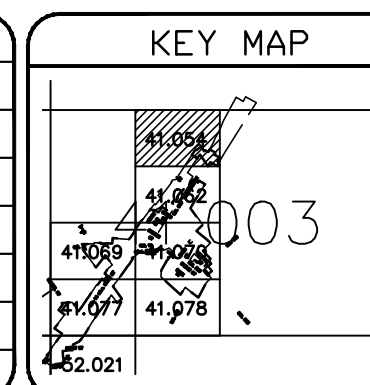

TOWN OF:	MADRID
DISTRICT NO.:	405600
Date of Conversion:	11/01/09 LDC

SECTION NO.	41.054
PROPERTY MAP	