

DUE TO SPACE CONSTRAINTS, NOT ALL THE PRIVATE RDS. ARE DRAWN ON THIS INDEX MAP. THE FOLLOWING IS A LIST OF ALL THE PRIVATE ROADS, AND THE CORRESPONDING SECTION NUMBER WHERE IT IS LOCATED.

- | | |
|--------------------------------|---------------------------------|
| 1) BAKUS CAMP RD | 86.002 |
| 2) BARR RD | 70.003 & 70.053 |
| 3) CAMP RD 41 | 70.003 & 70.053 |
| 4) LIVINGSTON DRIVE | 70.003 & 70.053 |
| 5) WELLS RD (PVT) | 70.003 & 70.053 |
| 6) WRIGHT CAMP DR (PVT) | 70.003 & 70.053 |
| 7) CHARBONWAY | 70.003, 70.045, 70.046 & 70.001 |
| 8) COUNTRY CLUB SHORES RD WEST | 70.038 |
| 9) MCEWEN LN (PVT) | 70.001 |
| 10) LORD DR (PVT) | 70.024 |
| 11) VIEWPOINT LANE | 70.024 |
| 12) BASTA BLVD. | 58.081 |
| 13) PECCOLO DR (PVT) | 58.058 & 58.059 |
| 14) BRIGGS STREET | 58.051 |
| 15) PEO'S LN (PVT) | 58.051 |
| 16) KLONWIKI RD (PVT) | 58.043 & 58.051 |
| 17) CEDAR CROFT | 70.024 |
| 18) CEDAR SHORES | 58.051 |
| 19) COUNTRY CLUB SHORES RD | 70.038 |
| 20) DUNN POINT RD | 70.038 & 70.046 |
| 21) EEL WEIR DR. | 71.001 |
| 22) TELL FARM RD. | 70.001, 70.023 & 70.024 |
| 23) MEMORY LN (PVT) | 84.004 |
| 24) CRYSTAL LN (PVT) | 85.003 |
| 25) RUPA RD (PVT) | 58.059 |
| 26) ROCK RD | 85.003 |
| 27) WILSON LN (PVT) | 85.001 |
| 28) LEE DR. | 71.001 |
| 29) PERRY RD. | 70.024 |
| 30) RIVER LN. | 71.001, 71.048 & 71.003 |
| 31) SIMMS SHORE RD. | 59.003 |
| 32) STONE HEDGE LN. | 58.051 |
| 33) ZONILLAR RD. | 85.039 |
| 34) DUBBY LN (PVT). | 70.001 |
| 35) HOWES PINE VIEW LN (PVT). | 71.001 & 71.048 |
| 36) SLEEPY HOLLOW LN (PVT). | 59.003 |

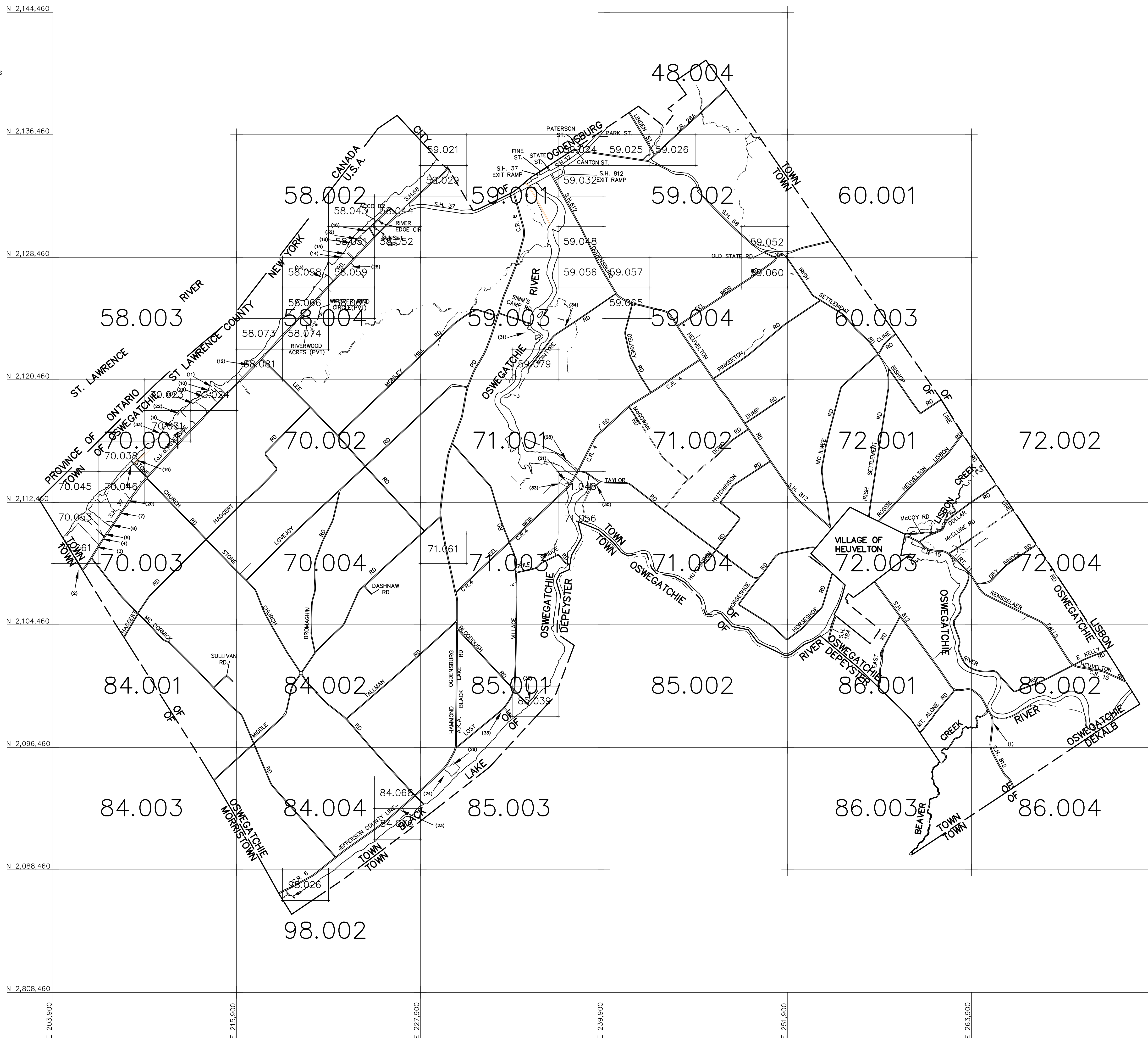

NOTE: A SERIES OF SQUARE OR RECTANGULAR PARCELS (OF LESS THAN ONE ACRE) HAVING TWO OR FOUR EQUAL SIDES ARE USUALLY DIMENSIONED ON THE FIRST AND LAST LINE OF THE SERIES ONLY. ALL THE OTHER PARALLEL LINES IN THIS SERIES OF LOTS ARE TO BE CONSIDERED AS BEING THE SAME LENGTH.

APPROVED BY NEW YORK BOARD OF EQUALIZATION AND ASSESSMENT

CASE NO. 1549 J TAGGART (AUTHORIZED SIGNATURE) JUNE 8, 1979

THIS MAP WAS PREPARED FOR TAX PURPOSES ONLY
NOT TO BE USED FOR CONVEYANCE

NOTICE OF DISCLAIMER
This map represents a compilation of graphical and textual information from deeds and surveys, a planimetric base map, and digital conversions of hand drawn mylar maps. Errors and omissions can occur from each of these sources; each source represents a large number of records and originators of information. As a practical matter, the County does not warrant the accuracy or completeness of the information portrayed. The end user of these maps agrees to accept the data "as is" with the full knowledge that errors and omissions may exist, and to hold harmless the County for any damages that may result from an inappropriate use of these maps.

DRAWING LEGEND
International Boundary
County Boundary
Town Boundary
Village Boundary
Property or R/W Line

Denotes Common Owner
Railroad
Water
Block Limit Line
Special District Line
Subdivision Lot Line

Block No. 1
Parcel No. 27
Subdivision Lot No. (10)
Deed Dimension 112'
Scaled Dimension 27'
Deed Area (27.3)
Calculated Area 148.2A(c)

ST. LAWRENCE COUNTY
NEW YORK
REAL PROPERTY
COUNTY OFFICE BUILDING
CANTON, NEW YORK 13617
(315) 379-2272 OFFICE
(315) 229-3222 FAX

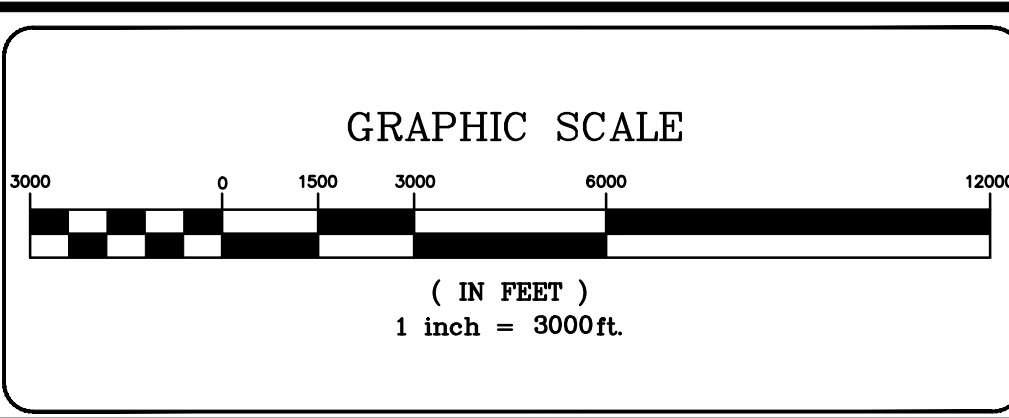

7	6	5	4	3	2	1
REVISIONS						
DATE BY						

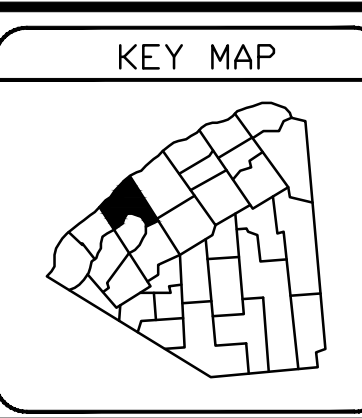

TOWN OF: OSWEGATCHIE
DISTRICT NO.: 406489
Date of Conversion: 11/1/2010 LDC

SECTION NO.
INDEX
PROPERTY MAP